

Humayun's Tomb

SITE MUSEUM

Following revitalization efforts undertaken by the Aga Khan Trust for Culture, the Humayun's Tomb Complex receives two million visitors annually. A greater number of pilgrims visit the adjoining Dargah of Hazrat Nizamuddin Auliya, the 14th century Sufi saint. Located at the entrance of a World Heritage Site, the Humayun's Tomb Site Museum will enhance visitor experience, allow a better understanding of Mughal architecture and craft, and explain the pluralist Sufi cultural traditions that defined Hindustani culture for five centuries.

Planning studies commenced to determine the most appropriate site to serve visitor needs as well as enhance interest in the Nizamuddin area – without disfiguring the historic character of the area or damaging any underlying archaeology and mature trees. The entrance zone was considered most appropriate as this would enable the Museum to serve as a bridge between the (presently) segregated sites of Humayun's Tomb, Sundar Nursery and the Hazrat Nizamuddin Basti. Ground-penetrating radar surveys (GPRS) confirmed the results of the archival research that showed that no archaeological remains existed on the site. AKTC commissioned a heritage impact assessment on the design prior to seeking planning approvals.

The architecture of the Museum has been inspired by
▼ the tradition of geometric forms in Mughal architecture.

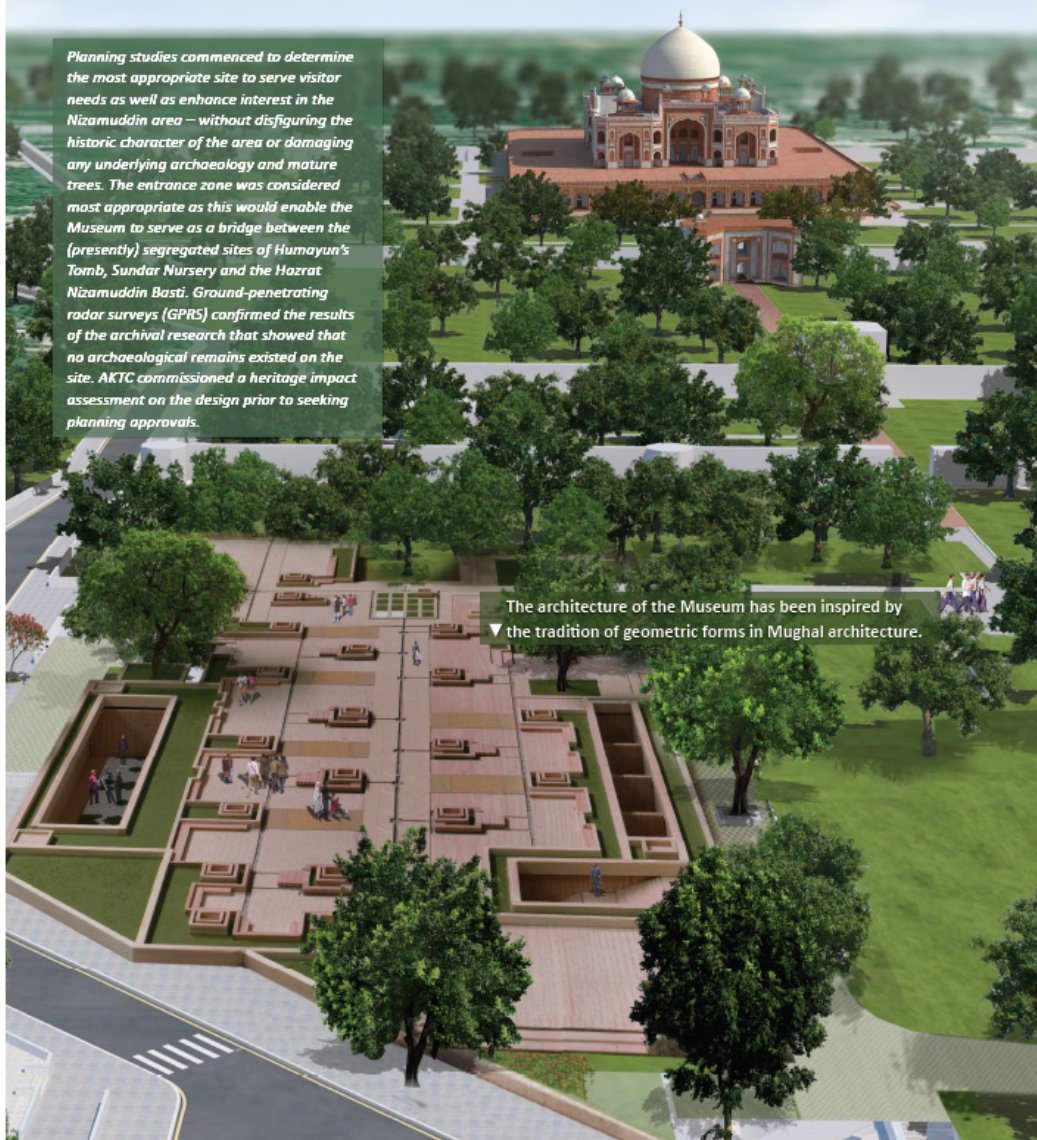

humayun's tomb site museum

Funded by the
Ministry of Tourism, Government of India

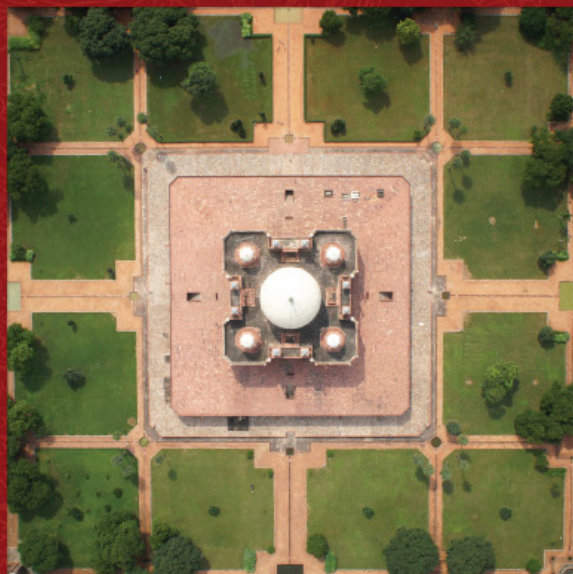

Architectural Design:
Vir Mueller Architects

Landscape Design:
Shaheer Associates

Structural Engineering:
Himanshu Parikh

MEP Consultants:
Jhaveri Associates

Acoustic Consultants:
Fifth Dimension Technologies

Archaeological Survey of India and Aga Khan Trust for Culture

The Architectural design of the Humayun's Tomb Site Museum
has been approved, amongst others, by:

National Monument Authority
Delhi Urban Art Commission
Delhi Development Authority
Chief Fire Officer, Government of Delhi
Land & Development Officer, Ministry of Urban Development,
Government of India
South Delhi Municipal Corporation
Chief Forest Officer, Government of Delhi



For more information on the project,
please visit: www.nizamuddinrenewal.org
for regular updates Like Us on:
www.facebook.com/NizamuddinRenewal

PARTNER AGENCIES



Archaeological Survey of India



Government of Delhi



Central Public Works Department



Aga Khan Foundation



Aga Khan Trust for Culture



PERMANENT GALLERY

The high-ceilinged Permanent Gallery, flanked by courtyards, reflects light from the marble floors and walls. Drawing from the reserve collections of the Archaeological Survey of India, this gallery will exhibit architectural

models and objects associated with the Mughal era. Reconstructions of prominent architectural elements of monuments and landscapes from the greater Nizamuddin area will also be featured.



SECTION A EXIT STAIR TO HUMAYUN'S TOMB

MATERIAL AND CRAFT

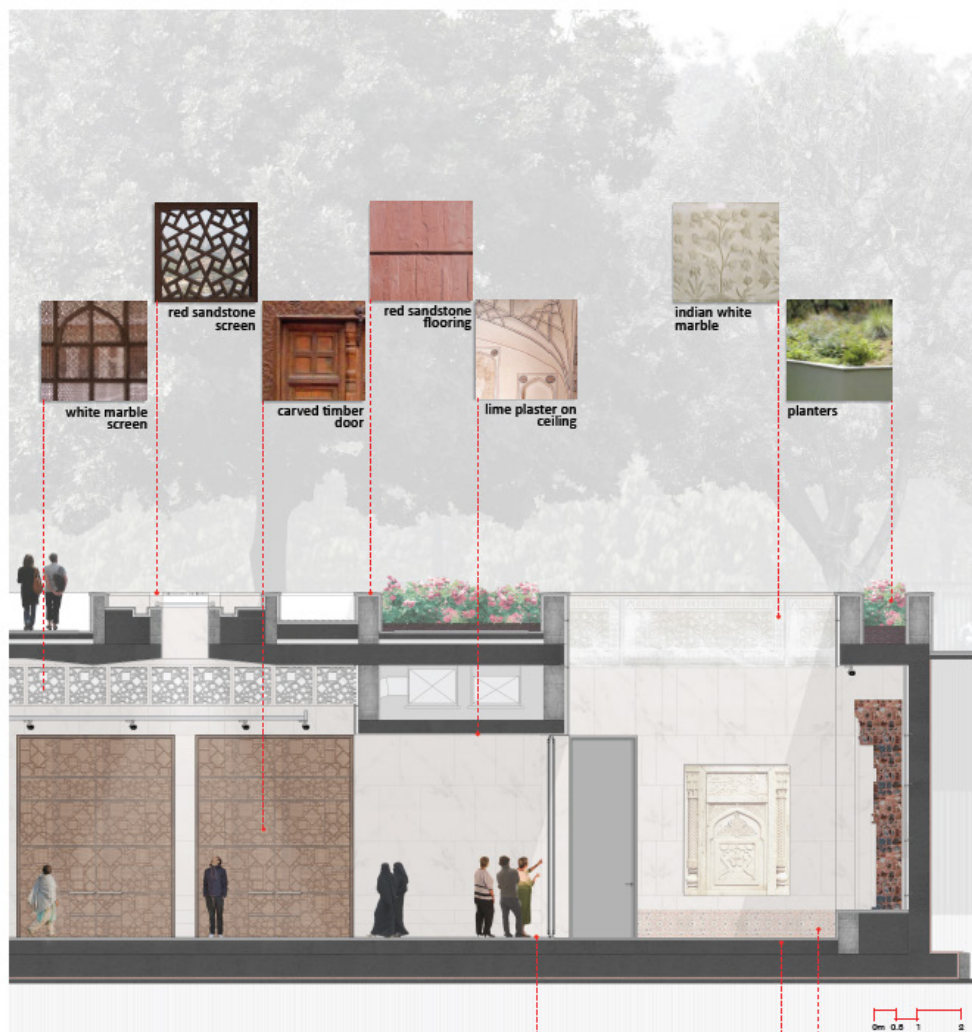

The Museum will enable visitors to experience the magnificent craft traditions that flourished during the Mughal period and which continue to thrive in contemporary India in myriad ways. Carved sandstone screens, engraved marble panels, ornate timber doors incised plaster ceilings, and inlaid tilework have been incorporated in architecture of the Museum.



marble flooring

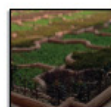

mughal courtyards



blue tile work



ENTRY RAMP TO THE MUSEUM

The illuminated plastered ceilings in the museum galleries reflect the geometric sophistication of the Mughal age. Live demonstration of building crafts such as stonework, tilework, incised plaster work, as well as prominent Mughal crafts such as metalwork, textiles and painting for manuscripts, will be a permanent activity.



01 Incised plaster medallion



02 Barakhamba Tomb Finial



03 Isa Khan Tomb



04 Humayun's Tomb Finial



FINIAL GALLERY



**SECTION B
CIRCULATION SEQUENCE THROUGH GALLERIES**

0m 5 10 20

MONUMENTS IN NIZAMUDDIN



Lal Mahal
SLAVE DYNASTY



Jamat Khanan Mosque
KHLIJI DYNASTY



Nila Gumbad
EARLY 16TH CENTURY



Afghah Khan's Tomb
1566



Lakkarwala Burj
16TH CENTURY



Rahims Tomb
17TH CENTURY



1310
Baoli



1388
Khan - I - Jahan Tilangani's Tomb



LODI DYNASTY
Barakhamba



1547
Isa Khan Niyazi's Tomb



17TH CENTURY
Jahannara's Tomb



18TH CENTURY
Mughal Pavilion

The Humayun's Tomb Site Museum will focus on bringing alive the seven centuries of pluralistic cultural traditions, art and architectural history of the Nizamuddin area in a meaningful, elegant and entertaining manner, appealing to a cross section of visitors, from school children to international tourists.



SECTION C
CIRCULATION SEQUENCE LINKING SUNDAR NURSERY AND HUMAYUN'S TOMB

0m 5 10 20

LANDSCAPE CONCEPT PLAN



CAFE COURT

Under the shade of a large existing tree, the entry plaza - comprising multiple ticket counters, public amenities, cafe, souvenir shop, as well as access to an auditorium, library, crafts' gallery and seminar rooms - is arranged under the foliage of large trees. Its facade is clad with carved red sandstone. The plaza functions as a threshold from where visitors may orient themselves within the many features of the area.



ENTRY PLAZA